



ASSEMBLY INSTRUCTIONS

MAXIMA 1, 2 ET 3

KOSMA

FOR DISC COULTER SEEDERS



Choosing a QDC-DXP[®] diffuser, optimizes the effectiveness of your microgranules and your seeds preservation!



To ensure the best preservation of your seeds, the microgranules need to be well positioned around the whole depth of the seed using a QDC-DXP[®] diffuser.

For this purpose, it is necessary to equip the micro granulator drop with a diffuser and to proceed with the assembly according to the brand and the type of the coulters or disc planter.

The kits for the QDC-DXP[®] diffusers installation together with their assembly instructions are available at your micro granule supplier.

Please follow the installation guidelines to optimize your micro granule's efficiency.

Application mode
for single seed seeders
(Maize, Sunflower, Sorghum)

It is important to carry out **a fine seedbed preparation** to ensure a uniform distribution of the microgranules over the entire seedbed section (see diagram below). The coarse preparations as well as a too deep seeding must be banned because they do not allow to realize an effective barrier of protection with your micro granulate around the seed. The optimum efficiency is achieved with **a seeding depth of 4 cm**.

In case of any doubts, please contact your distributor.

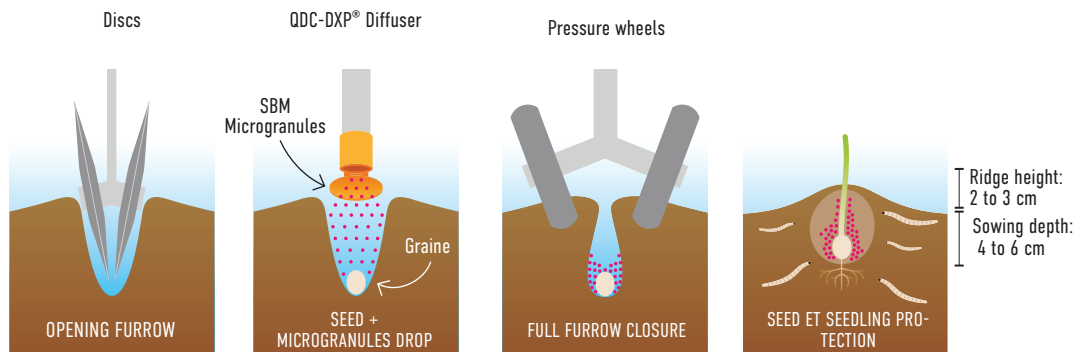

△ PRODUCT FOR PROFESSIONAL USE: PLEASE RESPECT THE TERMS AND CONDITIONS





To install the diffuser, you must order the **QDC-DXP®D** kit.

MAXIMA 1, 2 and 3 seed drills and KOSMA seed drills have the same microgranule distribution system.

In its micro granulator insecticide configuration, the seed drill has a micro granule tube for each seeding unit, onto which the diffuser fits. These can be obtained from your KHUN dealer. These tubes must be cut and shortened as shown in photo 3 below to fit the diffuser. We have the agreement of the manufacturer KUHN to cut these tubes. This has no negative impact on sowing quality.

Kit Component



Tools



Assembly

- Proceed with the wheel disassembly of the seeder component and remove the wheel. On some models it is necessary to remove the wheel arm - **Picture 1**
- Remove the beveled black plastic drop tube from its holder - **Picture 2**
- The black plastic drop tube has to be shortened at the elbow and at the base of the bevel. Fit the 25 mm QDC-DXP® diffuser directly on the black plastic tube - **Picture 3**
- Put back the tube and the diffuser as they were placed before and adjust them well to avoid any contact with the stainless steel wheel. Turn the diffuser towards the back for a good micro granule distribution - **Picture 4**
- Proceed with the reassembly of the seeder wheel or of the arm - **Picture 5**
- Check its position after a few hours of operation and generally throughout your seeding campaign.

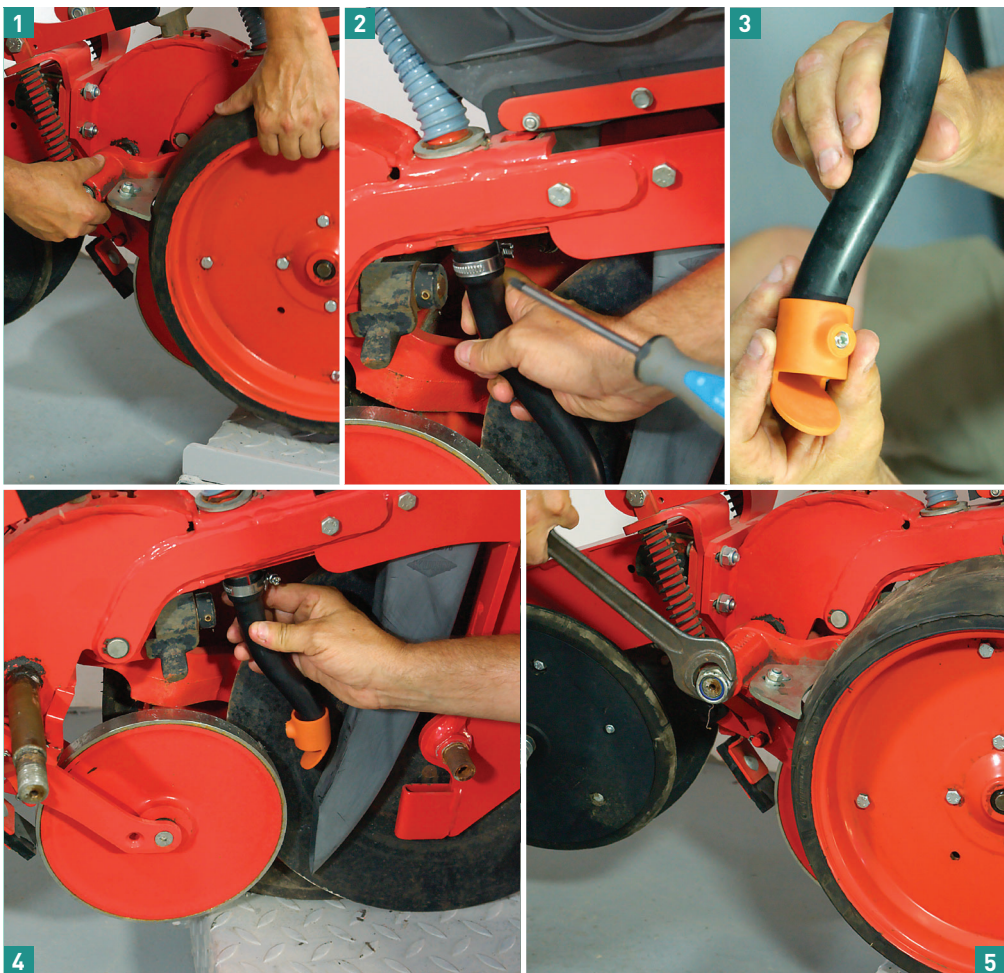

*In case of breakage, spare parts can be ordered from kits-sav.com, the supplier of the original kits.



TABLE OF MICROGRANULATOR SETTINGS

Determination of the microgranule dispenser settings for the application of soil insecticide to protect your maize, sunflower, sorghum and sweet corn sowing.

The microgranulator setting is crucial to apply the right dose of your microgranule and optimise its effectiveness against soil-borne pests.

Below are the indicative settings for the microgranule dispensers that provide a flow rate of around 12 kg/ha to be used for the application of microgranules.

For further settings, see <http://www.kits-sav.com>.

These flow rate values are indicative and should be checked regularly. They are valid for a sowing speed of 6 km/hour and according to the manufacturers' instructions.

For more details on microgranulator settings, we recommend that you contact your dealer or seed drill manufacturer.

| SETTINGS TABLE FOR A 12 KG/HA DOSE Bulk density of the unconsolidated product: 1,4 kg / litre | 80 cm width (96 g/100 m) | 75 cm width (90 g/100 m) | 60 cm width (72 g/100 m) | 50 cm width (60 g/100 m) | Settings mechanism |
|---|-----------------------------|-----------------------------|-----------------------------|-----------------------------|-----------------------|
| | Settings | Settings | Settings | Settings | |

KUHN PNII/PLII/MAXIMA

Insecticide rotor new frame <http://www.kits-sav.com>

| | | | | | |
|------------------------|----|------|-----|-----|-----------------|
| Drive pinion (top) | 20 | 16 | 16 | 16 | pinions + index |
| Driven pinion (bottom) | 16 | 20 | 20 | 20 | |
| Index position | 5 | 10.5 | 6.5 | 4.5 | |

NODET PNEUMASEM

Insecticide rotor previous frame <http://www.kits-sav.com>

| | | | | | |
|------------------------|-----|-----|-----|----|-----------------|
| Drive pinion (top) | 16 | 16 | 12 | 12 | pinions + index |
| Driven pinion (bottom) | 20 | 20 | 24 | 24 | |
| Index position | 5,5 | 4.5 | 7.5 | 5 | |

MONOSEM MICROSEM

Insecticide rotor current model <http://www.kits-sav.com>

| | | | | | |
|----------|----|----|----|----|-----------------|
| Pinion A | 12 | 25 | 12 | 12 | 2-stage pinions |
| Pinion B | 18 | 25 | 25 | 18 | |
| Pinion C | 20 | 12 | 20 | 12 | |

MONOSEM MICROSEM

Microsem with variable drive <http://www.kits-sav.com>

MASCHIO GASPARDO

Insecticide rotor <http://www.kits-sav.com>

| | | | | | |
|----------------|----|----|----|------|---------|
| Index position | A9 | A8 | A5 | A3,5 | Pinions |
|----------------|----|----|----|------|---------|

TECHNICAL TEAMS AT YOUR SERVICE



WEBSITE

www.kits-sav.com



E-MAIL ADDRESS

kits.sav@sbm-company.com



HOTLINE

+ 33 (0) 6 72 40 94 31

SBM Développement declines all liability for the efficacy of the soil microgranule insecticide products approved and manufactured by SBM Développement or its subsidiaries («SBM Microgranules»), requiring the use of the QDC-DXP® in the following cases:

- If SBM Micro Granules are applied with non-recommended equipment, or if the QDC-DXP® diffuser assembly or the settings are not compliant with the technical specifications given by the company or its dealers.
- If SBM Micro Granules are not applied with the QDC-DXP® diffuser specially designed to do so, or if the application is carried out without a diffuser.

As the QDC-DXP® diffuser was specifically designed for the application of SBM microgranules, SBM Développement declines all liability for the use of the QDC-DXP® to apply products other than SBM Microgranules.

