



ASSEMBLY INSTRUCTIONS

KIT QDC-DXP®-D

FOR DISC COULTER SEEDERS

Choosing a QDC-DXP® diffuser, optimizes the effectiveness of your microgranules and your seeds preservation!

To ensure the best preservation of your seeds, the microgranules need to be well positioned around the whole depth of the seed using a QDC-DXP® diffuser.

For this purpose, it is necessary to equip the micro granulator drop with a diffuser and to proceed with the assembly according to the brand and the type of the coulter or disc planter.

The kits for the QDC-DXP® diffusers installation together with their assembly instructions are available at your micro granule supplier.

Please follow the installation guidelines to optimize your micro granule's efficiency.



Application mode
for single seed seeders
(Maize, Sunflower, Sorghum)

It is important to carry out a **fine seedbed preparation** to ensure a uniform distribution of the microgranules over the entire seedbed section (see diagram below). The coarse preparations as well as a too deep seeding must be banned because they do not allow to realize an effective barrier of protection with your micro granulate around the seed. The optimum efficiency is achieved with a **seeding depth of 4 cm**.

In case of any doubts, please contact your distributor.

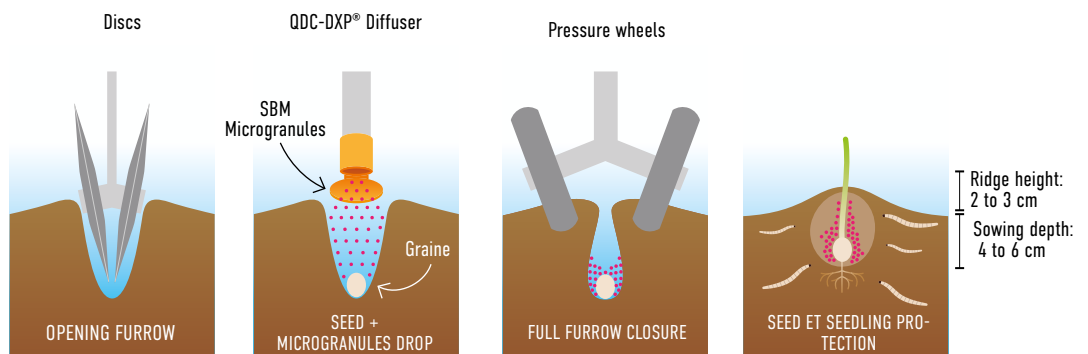

⚠ PRODUCT FOR PROFESSIONAL USE: PLEASE RESPECT THE TERMS AND CONDITIONS

MONOSEM / NX | NGPLUS 1-4, M



This assembly, fitting the original tube, enables to well position the diffuser axis and to get an optimal distribution of the microgranule insecticide all around the seed.

Kit Components



Tools



To install the diffuser, you must order the QDC-DXP®D kit.



This assembly is suitable for seeders with or without pro wheel.

Assembly

- Unscrew the 2 bolts of the micro tube from the seeder - **Picture 1**
- Shorten the drop tube by 10 cm from the basis - **Picture 2**
- Install the QDC-DXP® diffuser on the extension tubes - **Pictures 3 & 4**
 - The blue [P36] corresponds to the left side of the seeder unit.
 - The white one (engraved P36D) for the installation on the right side of the seeder unit.
- Put the clamp on the top of the tube and tighten it slightly.
- Put the assembly in the seeder, making sure to hold the micro tube mounting plate vertically and adjust by rotating the extension tube to align the diffuser with the vertical axis - **Picture 5**
- Make sure the diffuser is correctly facing backwards to diffuse the microgranules.
- Tighten the clamp and diffuser permanently - **Picture 6**

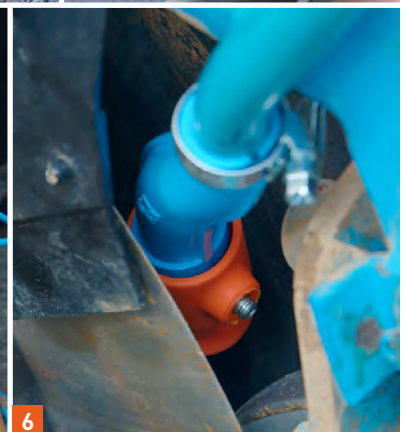
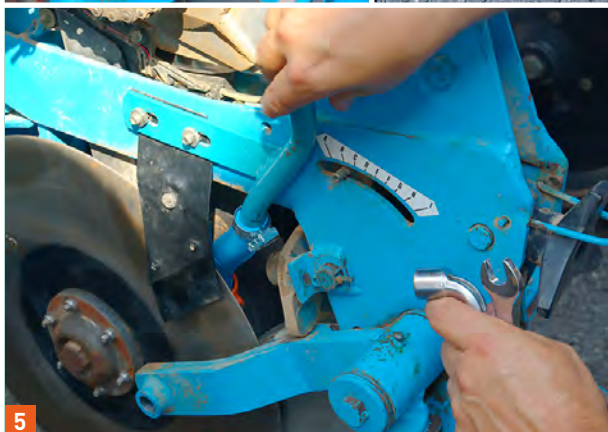



Kit Component



Tools



To install the diffuser, you must order the **QDC-DXP®D** kit.

The seeder with the micro granular insecticide design has a micro granular tube for each seeding unit, on which the diffuser is fitted. It can be purchased from your KHUN distributor.

Assembly

- Proceed with the wheel disassembly of the seeder component and remove the wheel. On some models it is necessary to remove the wheel arm - **Picture 1**
- Remove the beveled black plastic drop tube from its holder - **Picture 2**
- The black plastic drop tube has to be shortened at the elbow and at the base of the bevel. Fit the 25 mm QDC-DXP® diffuser directly on the black plastic tube - **Picture 3**
- Put back the tube and the diffuser as they were placed before and adjust them well to avoid any contact with the stainless steel wheel. Turn the diffuser towards the back for a good micro granule distribution - **Picture 4**
- Proceed with the reassembly of the seeder wheel or of the arm - **Picture 5**
- Check its position after a few hours of operation and generally throughout your seeding campaign.

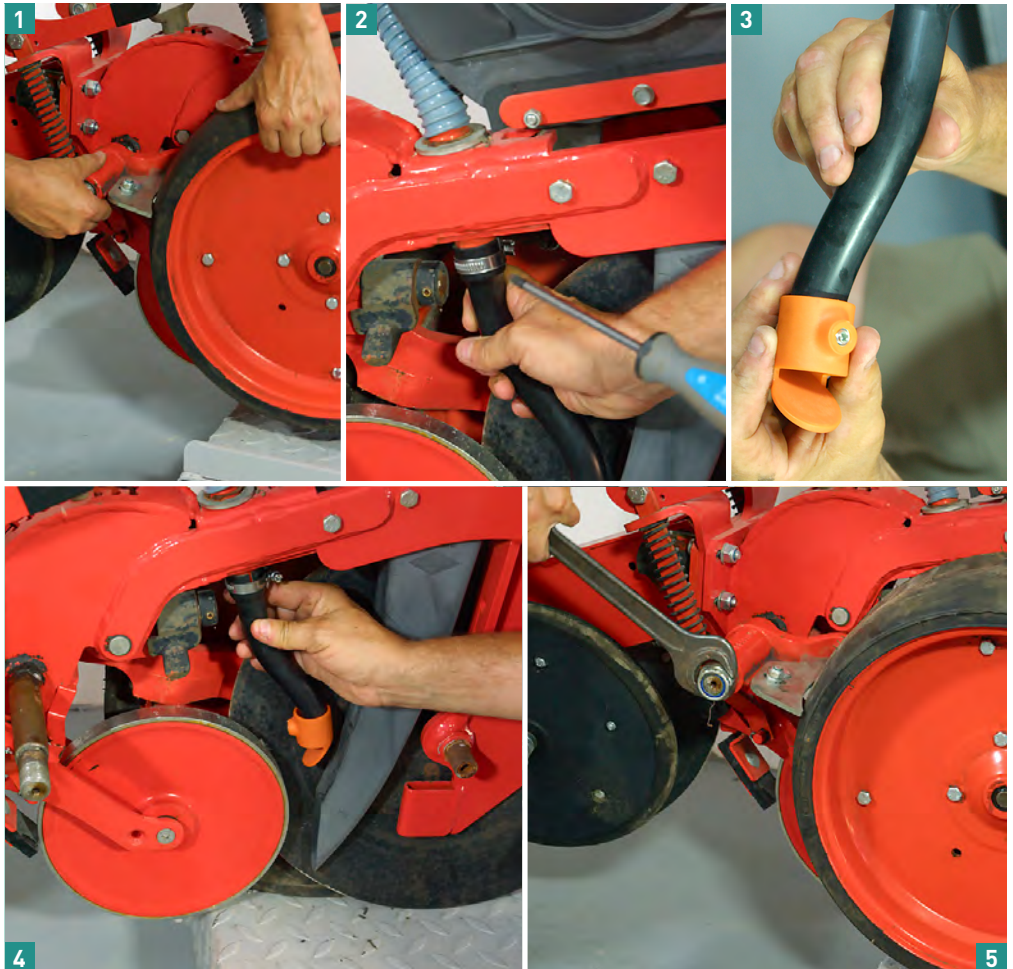

GASPARDO | TYPE MT, MAGICA



Kit Components

- a. Diffusers
- b. Clamps
- c. Reducers



Tools



To install the diffuser, you must order the **QDC-DXP®D** kit



The seeder needs to be installed with the micro insecticide tube. If it's not available, you can buy it from the distributor.

Assembly

- Remove the seeder wheel by the wheel arm bolt.
- Remove the drop tube from its place by unscrewing the fixing nut. It is necessary to release the plate fixing the distribution box to ease the tube's insertion and removal - **Pictures 1 et 2**
- Cut the micro insecticide tube in its pointed part at about 8 to 12 cm from the tip depending on the micro tube models - **Picture 3**
- Put the tube back in its original place without securing it - **Picture 4**
- Set up the QDC-DXP® diffuser and clamp it to the reducer, then install and tighten the clamp very slightly on the reducer - **Picture 5**
- Put the whole assembly on the Gaspardo's micro tube, showing the reducer and the diffuser from the bottom - **Picture 6**
- Adjust and tighten the clamp to ensure that the QDC-DXP® diffuser vane is facing backwards - **Picture 7**
- Lastly, fix the plate again to block the distribution box - **Picture 8**
- Clamp the drop tube to the unit body, reinstall the tube from the micro granulator and reassemble the wheel - **Picture 9**

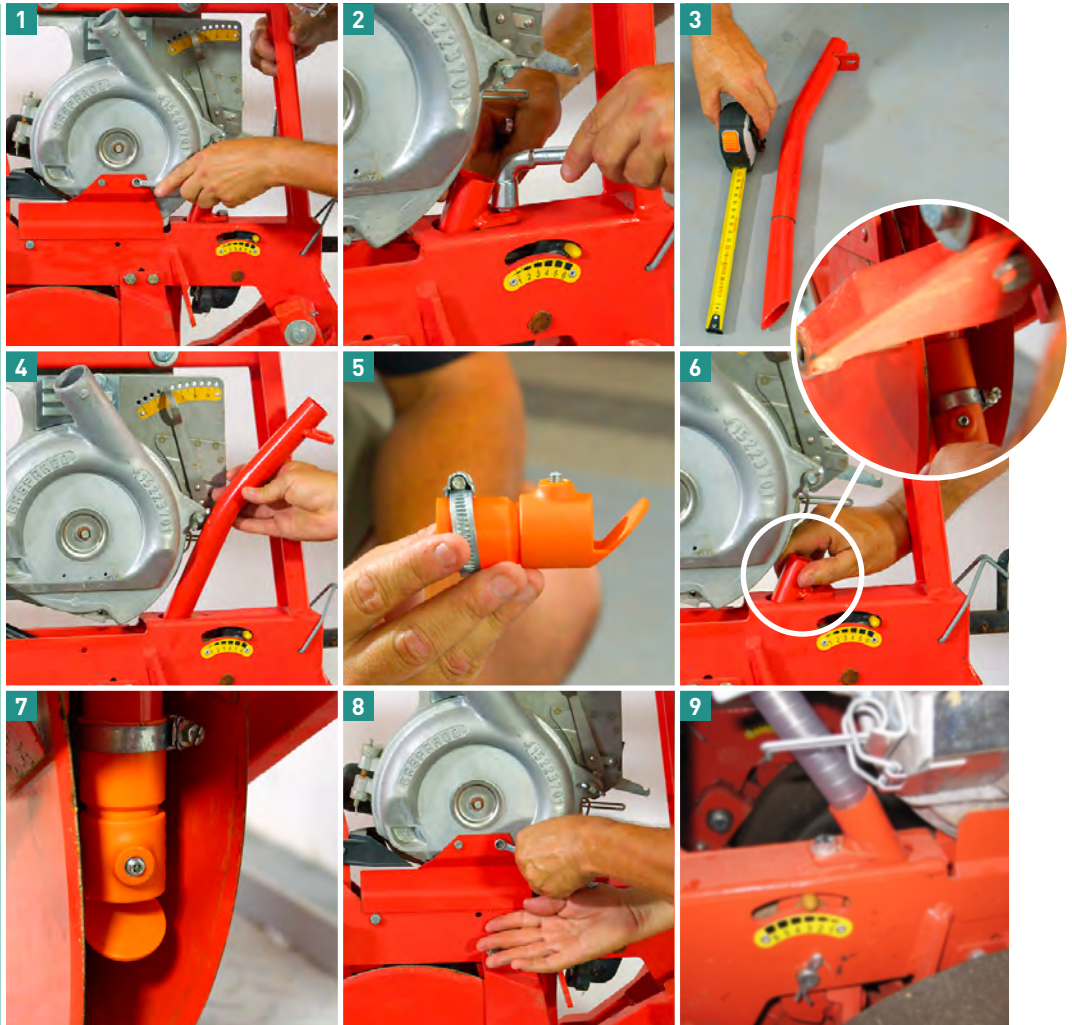

QDC-DXP® DIFFUSER ASSEMBLY

SOLA | PROSEM K



Kit Components



Tools



To install the diffuser, you must order the **QDC-DXP®D** kit.

The seeder with the micro granular insecticide design has a micro granular metal tube for each seeding unit, on which the diffuser is fitted. It can be purchased from your PROSEM SOLA distributor.

Assembly

- Remove the drop tube from its place - **Picture 1**
- Shorten it by sawing over the bevel - **Picture 2**
- Fix the reducer on the 25 mm QDC-DXP® diffuser and put the clamp - **Picture 3**
- Put the drop tube back into its place first and then fix the diffuser and its reducer - **Picture 4**
- Adjust the assembly to face the diffuser backwards and secure it using the clamp - **Picture 5**
- Finish mounting the micro granule drop tube on the element and then attach it to the micro granulator tube of your seeder - **Picture 6**
- Reassemble the wheel - **Picture 7**
- Check the positioning after a few hours of operation and generally throughout your seeding campaign.



QDC-DXP® DIFFUSER ASSEMBLY

HORSCH | MAESTRO



Kit Components



To install the diffuser, you must order the **QDC-DXP®D** kit

The seeder with the micro granular insecticide design has a metal micro granular tube for each seeding unit, on which the diffuser is fitted. It can be purchased as spare part from your HORSCH distributor.



Assembly

- Disassemble and remove the gauge wheel from the seeder component as well as the the opening disc to reach the original metal micro granule slope - **Pictures 1 & 2**
- Install the QDC-DXP diffuser with a diameter of 25 mm directly on the drop tube between the two discs. Point the diffuser towards the rear of the seeder unit - **Pictures 3, 4 & 5**
- When using the press wheel, make sure that there is no contact or friction.
- Reassemble the disk and wheel set.
- Adjust the air flow to ensure that the micro granules are evenly positioned in the V-shaped groove.

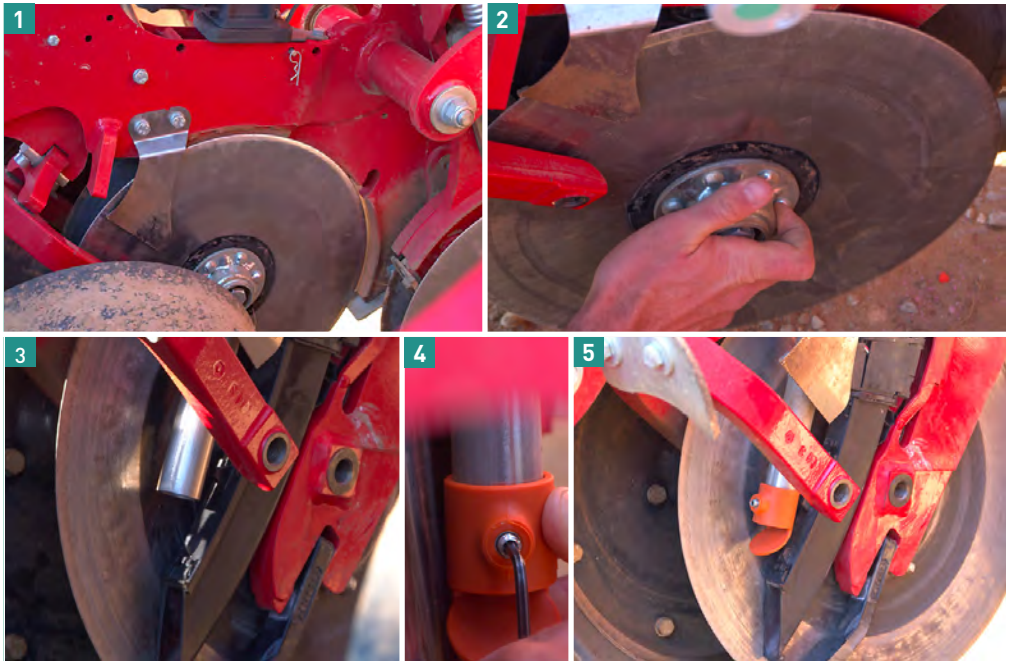

TECHNICAL TEAMS AT YOUR SERVICE



WEBSITE

www.kits-sav.com



EMAIL ADDRESS

kits.sav@sbm-company.com



HOTLINE

+ 33 (0) 6 72 40 94 31