



ASSEMBLY INSTRUCTIONS

KIT QDC-DXP®-D

FOR DISC COULTER SEEDERS

Choosing a QDC-DXP® diffuser, optimizes the effectiveness of your microgranules and your seeds preservation!

To ensure the best preservation of your seeds, the microgranules need to be well positioned around the whole depth of the seed using a QDC-DXP® diffuser.

For this purpose, it is necessary to equip the micro granulator drop with a diffuser and to proceed with the assembly according to the brand and the type of the coulters or disc planter.

The kits for the QDC-DXP® diffusers installation together with their assembly instructions are available at your micro granule supplier.

Please follow the installation guidelines to optimize your micro granule's efficiency.



Application mode
for single seed seeders
(Maize, Sunflower, Sorghum)

It is important to carry out a **fine seedbed preparation** to ensure a uniform distribution of the microgranules over the entire seedbed section (see diagram below). The coarse preparations as well as a too deep seeding must be banned because they do not allow to realize an effective barrier of protection with your micro granulate around the seed. The optimum efficiency is achieved with a **seeding depth of 4 cm**.

In case of any doubts, please contact your distributor.

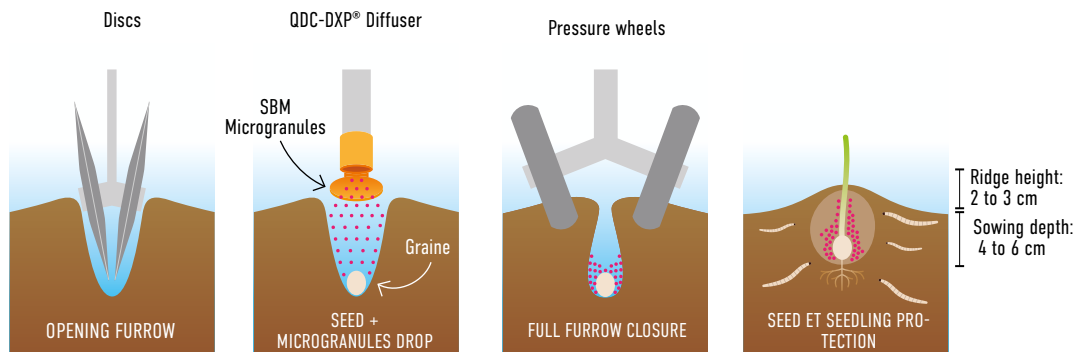

⚠ PRODUCT FOR PROFESSIONAL USE: PLEASE RESPECT THE TERMS AND CONDITIONS



GASPARDO | TYPE MT, MAGICA



Kit Components

- a. Diffusers
- b. Clamps
- c. Reducers



Tools



To install the diffuser, you must order the **QDC-DXP®D** kit



The seeder needs to be installed with the micro insecticide tube. If it's not available, you can buy it from the distributor.

Assembly

- Remove the seeder wheel by the wheel arm bolt.
- Remove the drop tube from its place by unscrewing the fixing nut. It is necessary to release the plate fixing the distribution box to ease the tube's insertion and removal - **Pictures 1 et 2**
- Cut the micro insecticide tube in its pointed part at about 8 to 12 cm from the tip depending on the micro tube models - **Picture 3**
- Put the tube back in its original place without securing it - **Picture 4**
- Set up the QDC-DXP® diffuser and clamp it to the reducer, then install and tighten the clamp very slightly on the reducer - **Picture 5**
- Put the whole assembly on the Gaspardo's micro tube, showing the reducer and the diffuser from the bottom - **Picture 6**
- Adjust and tighten the clamp to ensure that the QDC-DXP® diffuser vane is facing backwards - **Picture 7**
- Lastly, fix the plate again to block the distribution box - **Picture 8**
- Clamp the drop tube to the unit body, reinstall the tube from the micro granulator and reassemble the wheel - **Picture 9**

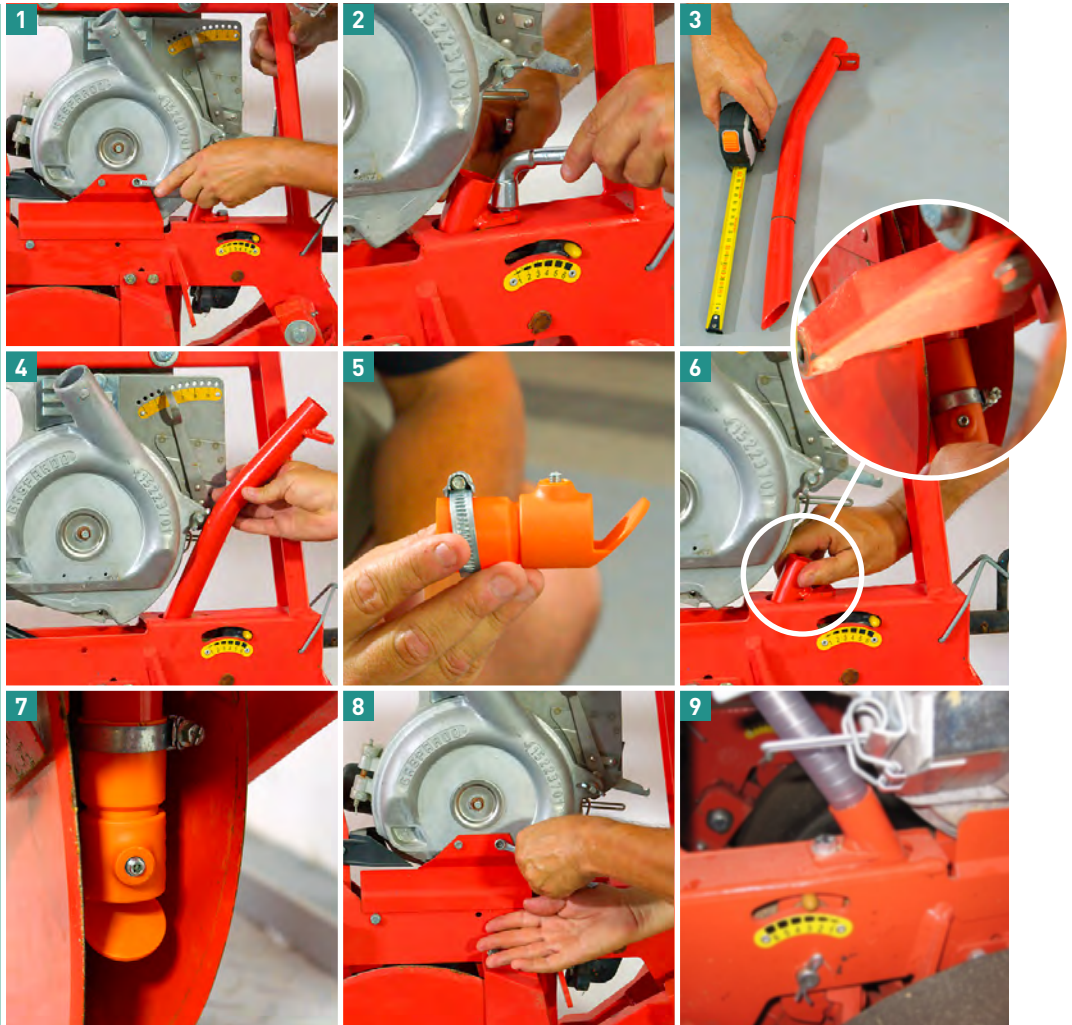

TABLE OF MICROGRANULATOR SETTINGS

Determination of the microgranule dispenser settings for the application of soil insecticide to protect your maize, sunflower, sorghum and sweet corn sowing.

The microgranulator setting is crucial to apply the right dose of your microgranule and optimise its effectiveness against soil-borne pests.

Below are the indicative settings for the microgranule dispensers that provide a flow rate of around 12 kg/ha to be used for the application of microgranules.

For further settings, see <http://www.kits-sav.com>.

These flow rate values are indicative and should be checked regularly. They are valid for a sowing speed of 6 km/hour and according to the manufacturers' instructions.

SETTINGS TABLE FOR A 12 KG/HA DOSE Bulk density of the unconsolidated product: 1,4 kg / litre	80 cm width (96 g/100 m)	75 cm width (90 g/100 m)	60 cm width (72 g/100 m)	50 cm width (60 g/100 m)	Settings mechanism
	Settings	Settings	Settings	Settings	
KUHN PNII/PLII/MAXIMA					
Insecticide rotor new frame	http://www.kits-sav.com				
Drive pinion (top)	20	16	16	16	pinions + index
Driven pinion (bottom)	16	20	20	20	
Index position	5	10.5	6.5	4.5	
NODET PNEUMASEM					
Insecticide rotor previous frame	http://www.kits-sav.com				
Drive pinion (top)	16	16	12	12	pinions + index
Driven pinion (bottom)	20	20	24	24	
Index position	5,5	4.5	7.5	5	
MONOSEM MICROSEM					
Insecticide rotor current model	http://www.kits-sav.com				
Pinion A	12	25	12	12	2-stage pinions
Pinion B	18	25	25	18	
Pinion C	20	12	20	12	
MONOSEM MICROSEM					
Microsem with variable drive	http://www.kits-sav.com				
MASCHIO GASPARDO					
Insecticide rotor	http://www.kits-sav.com				
Index position	A9	A8	A5	A3,5	Pinions

SBM Développement declines all liability for the efficacy of the soil microgranule insecticide products approved and manufactured by SBM Développement or its subsidiaries («SBM Microgranules»), requiring the use of the QDC-DXP® in the following cases:

- If SBM Micro Granules are applied with non-recommended equipment, or if the QDC-DXP® diffuser assembly or the settings are not compliant with the technical specifications given by the company or its dealers.
- If SBM Micro Granules are not applied with the QDC-DXP® diffuser specially designed to do so, or if the application is carried out without a diffuser.

As the QDC-DXP® diffuser was specifically designed for the application of SBM microgranules. SBM Développement declines all liability for the use of the QDC-DXP® to apply products other than SBM Microgranules.

TECHNICAL TEAMS AT YOUR SERVICE



WEBSITE

www.kits-sav.com



EMAIL ADDRESS

kits.sav@sbm-company.com



HOTLINE

+ 33 (0) 6 72 40 94 31